

PA-SOD-4001-D560-xx/2 Data Sheet

32 or 40 pin SO socket/32 or 40 pin SO-Plugs

Supported Device/Footprints

Using this adapter, 32 or 40 pin SO packages with a body width of 11.4mm and lead pitch of 1.27mm can be socketed over their PCB footprints.

Device Dimensions

This socket accepts devices of the following dimensions:

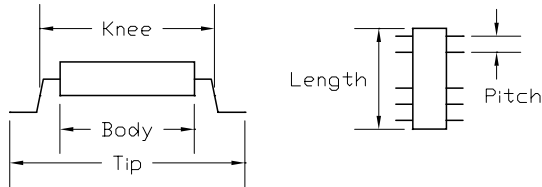

Body	Knee	Tip	Pitch	Length
11.4 mm typ	12.4 mm	14.1 mm	1.27 mm	n/a

Adapter Dimensions

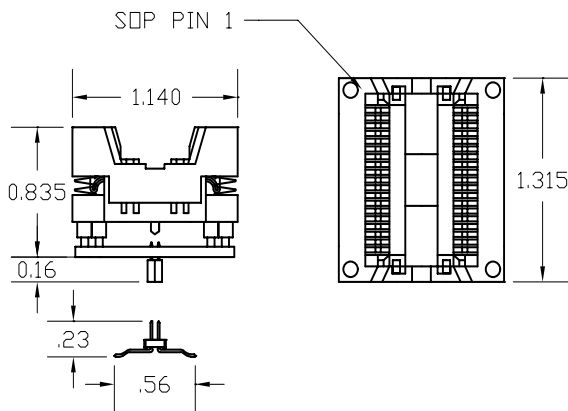

Adapter Construction

The adapter is made up of 2 sub-assemblies. They assemble via connectors making the adapter modular. This way the sub-assemblies can be replaced easily.

When disassembling the adapter take care not to bend the pins. When reassembling the adapter note the pin 1 indicators to align the parts correctly.

The following chart lists the adapters described by this datasheet and their subassemblies.

Adapter	Test Socket	Board	Plug
PA-SOD-4001-D560-40/2	40SD-01	4001-SOD	SOF-D560-40/2
PA-SOD-4001-D560-32/2	32SD-01	4001-SOD	SOF-D560-32/2

Other SO-Plugs will also mate with this adapter, contact us if you want assistance matching plugs to this adapter.

Test Sockets

LSC #	Style	Mfgr/Pn
40SD-01	Open Top	Enplas OTS-40-1.27-01
32SD-01	Open Top	Enplas OTS-32-1.27-01

Notes

1. For all versions of the adapter, the board provides 40 positions to receive the SO-Plug. When using plugs with less than 40 pins orient the plug and the device, away from the pin 1 end of the board.

Wiring

Wiring is 1 to 1. Pin 1 of the SO device is wired to pin 1 of the plug. Pin 2 to pin 2 and so on around the adapter.

LOGICAL

Logical Systems Corporation
 PO Box 6184, Syracuse, NY 13217-6184 USA
 Tel (315) 478-0722, FAX (315) 479-6753
 www.logicals.com, Email: info@logicals.com

PA-SOD-4001-D560-xx/2 Data Sheet
 Doc: SOD4001-2.DOC
 Rev 02/13/2004
 Page 1 of 1